

6 SIDE WALL STEM INSULATION
1/2" = 1'-0"

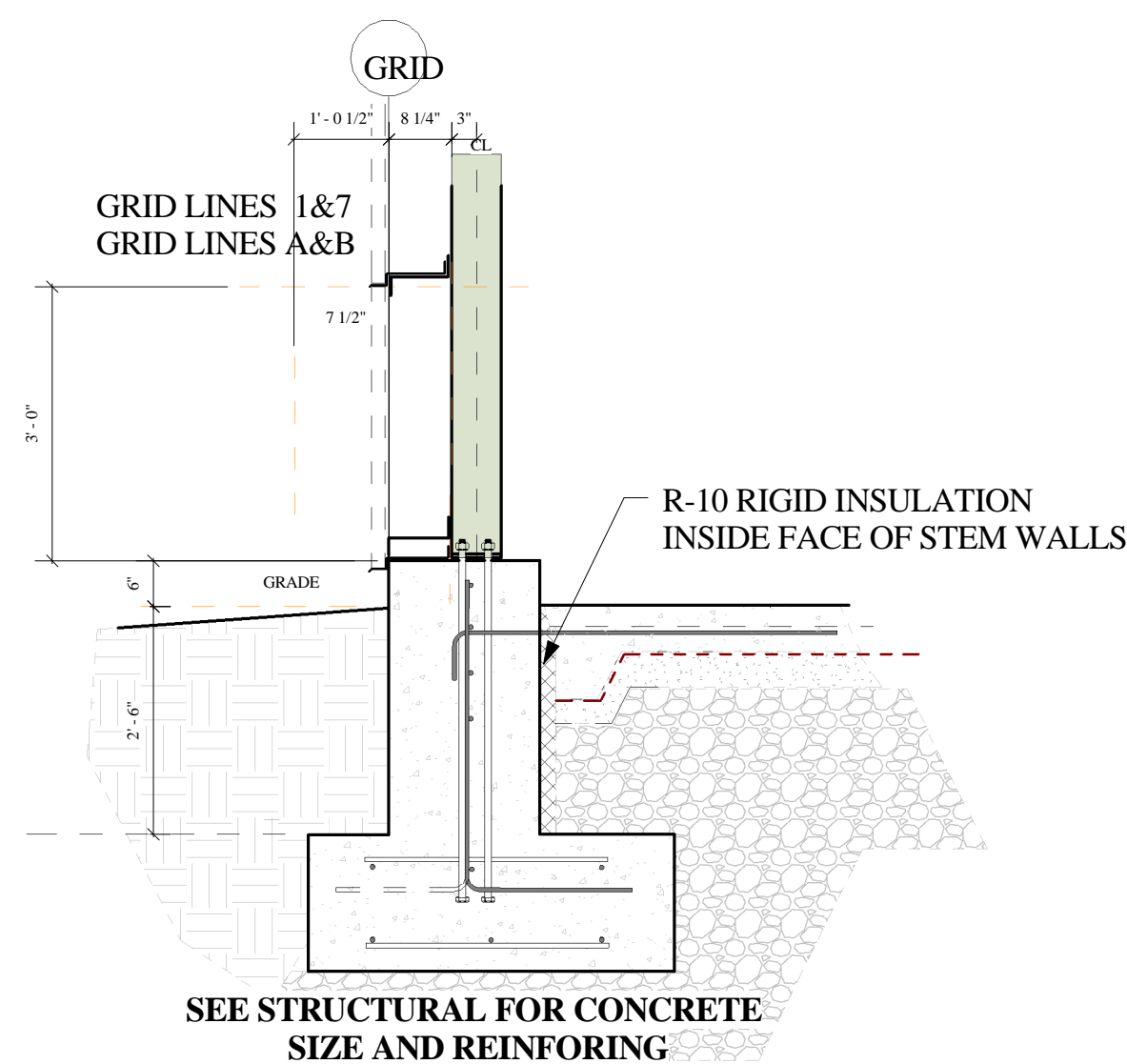

5 END WALL STEM INSULATION
1/2" = 1'-0"

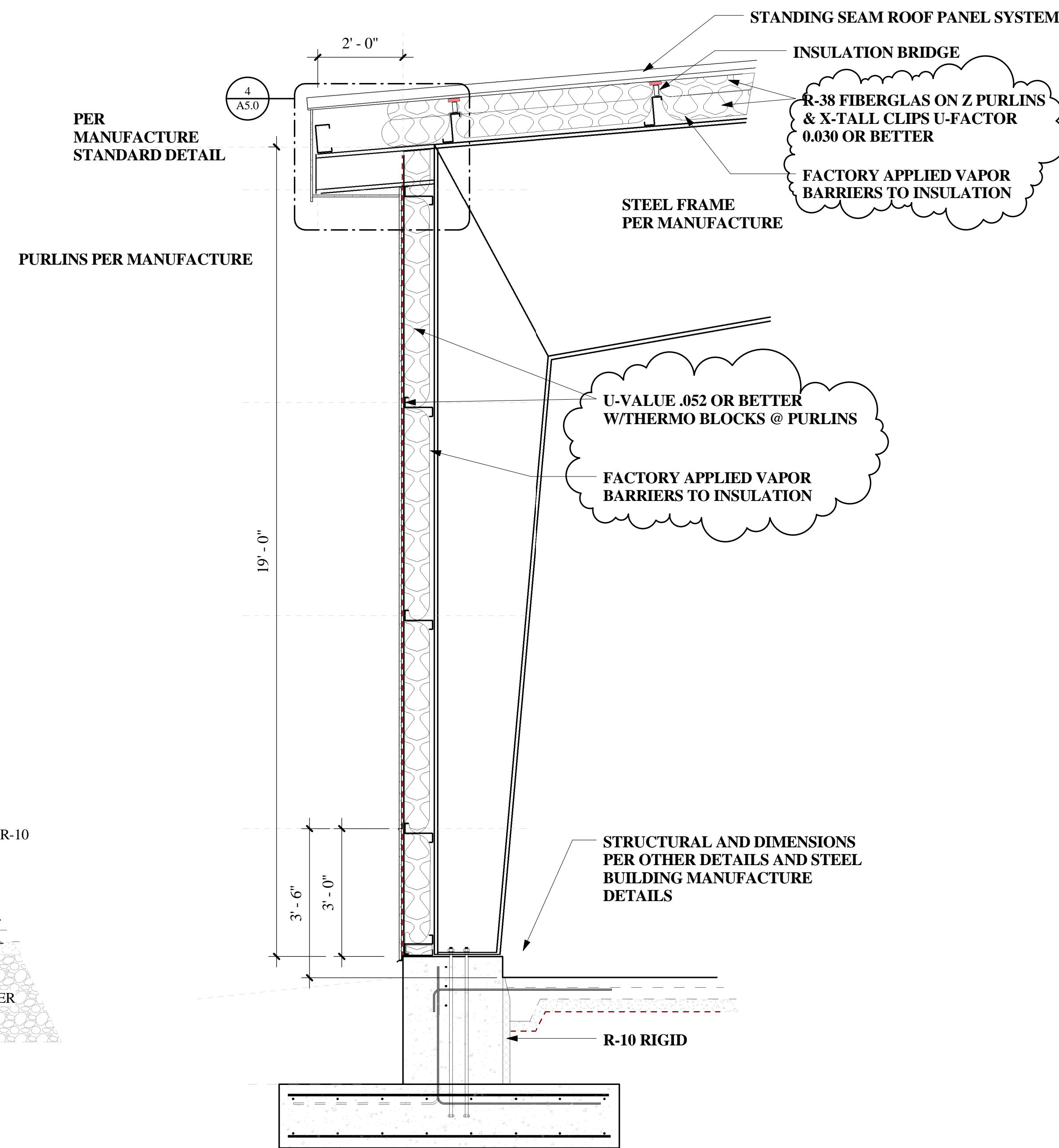

1 WALL SECTION A1
1/2" = 1'-0"

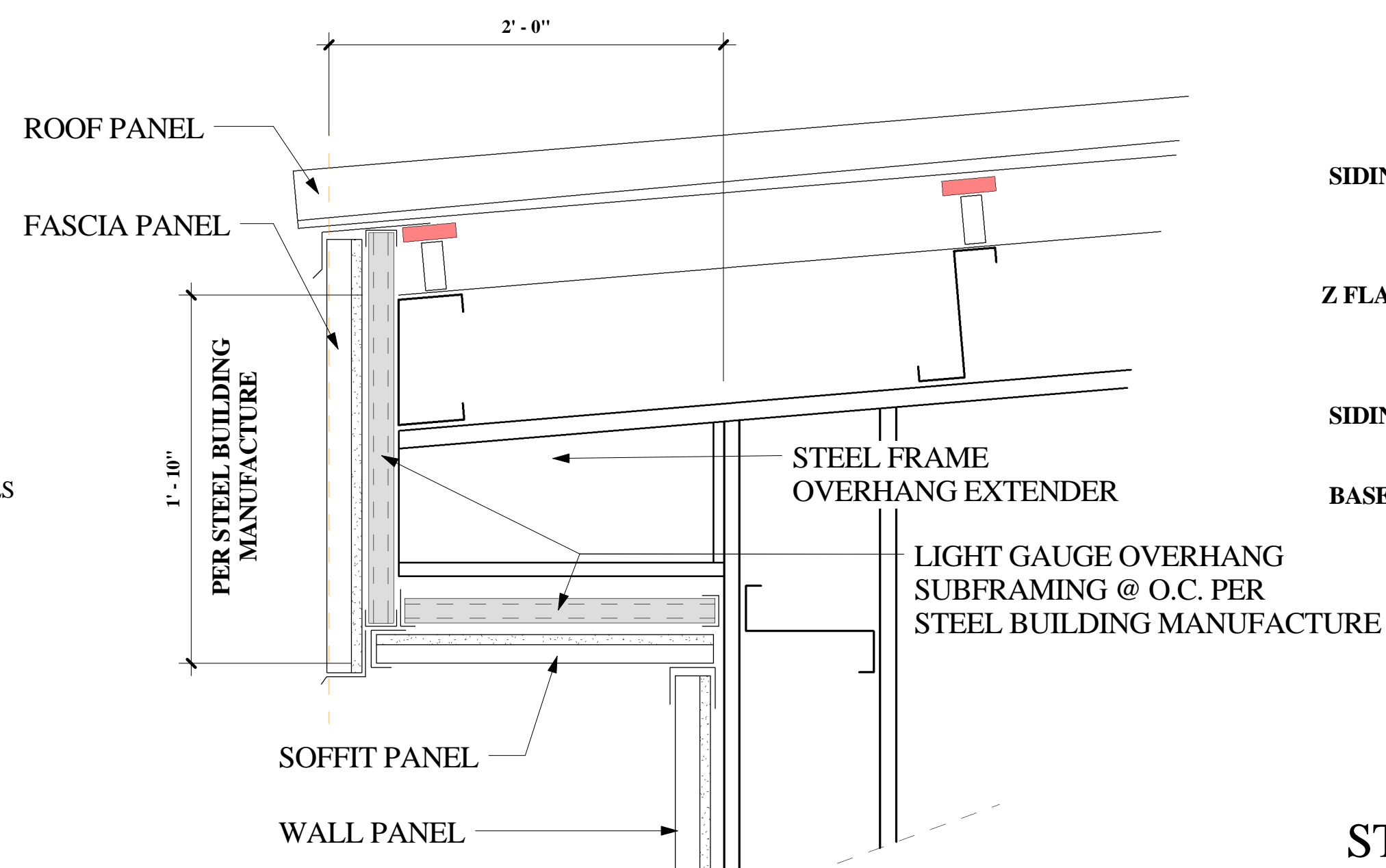

4 OVERHANG
1 1/2" = 1'-0"

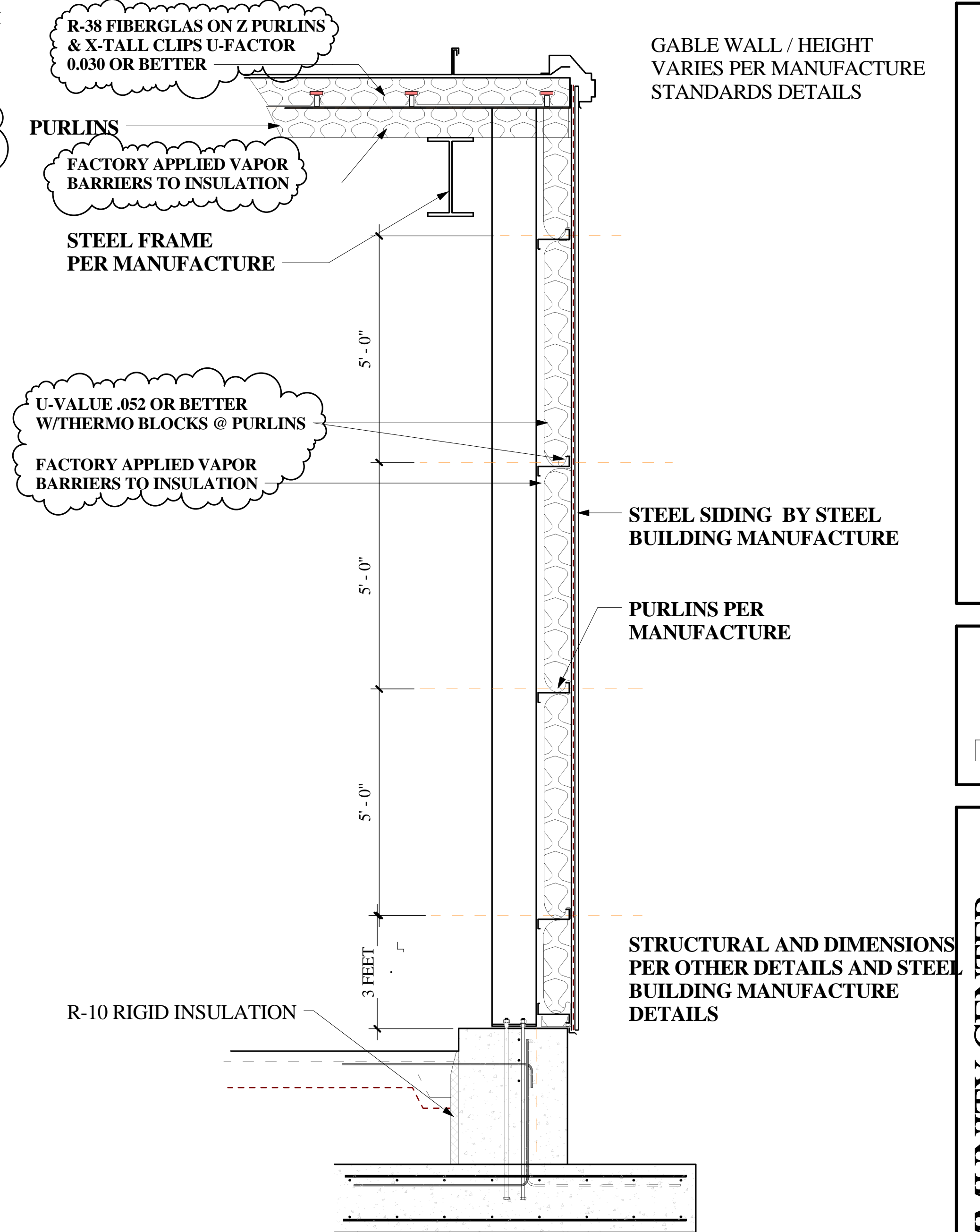

2 WALL SECTION A2
1/2" = 1'-0"

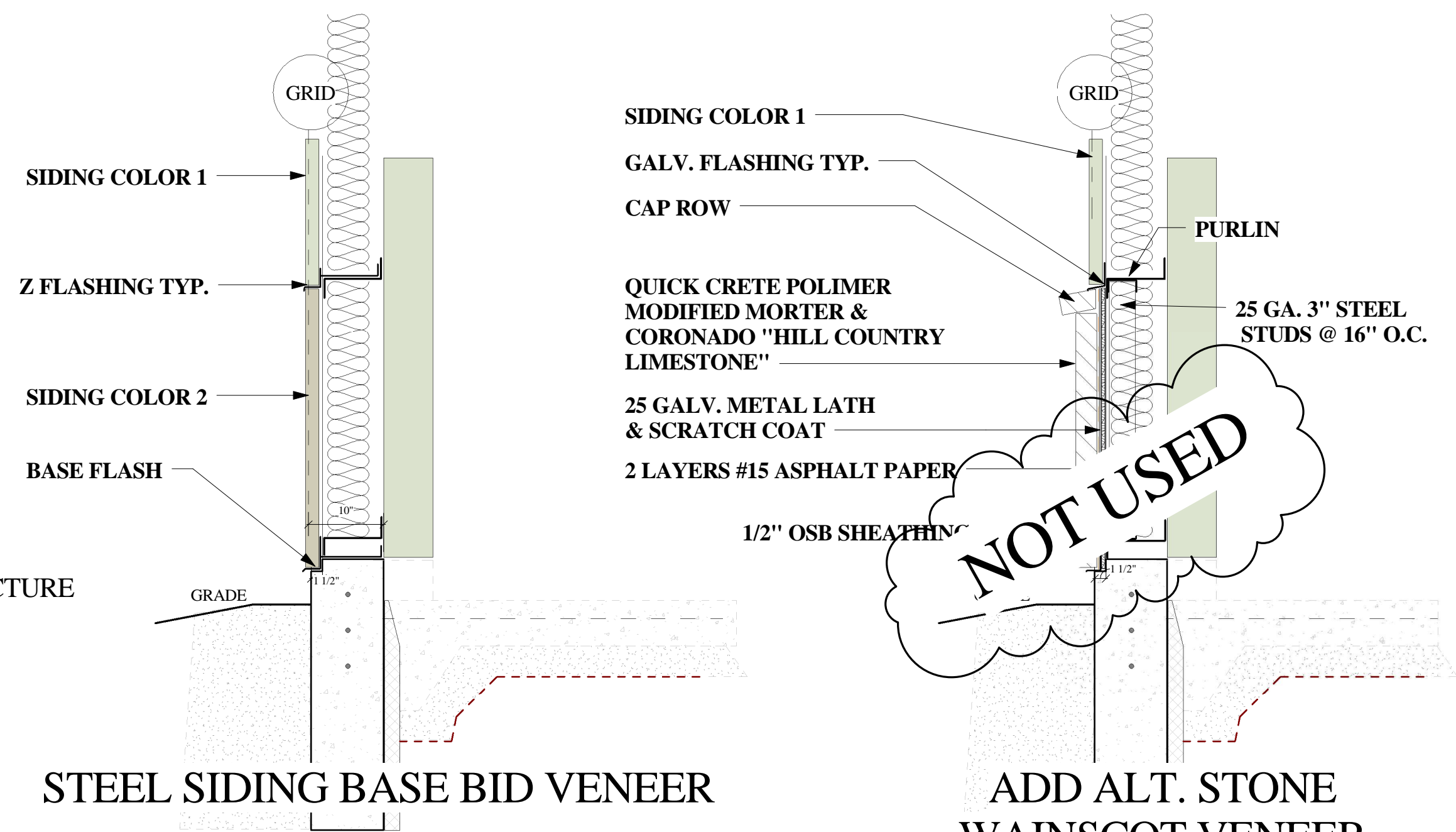

3 WAINSCOT DETAIL
3/4" = 1'-0"

NOT USED

ADD ALT. STONE WAINSCOT VENEER
SHEET REVISED 10/24/2018

Planning
TRW
Architecture
CHTD.

515 EAST PARKWAY CT.
Boise, Idaho 83706
208.371.9298
trw@trwarchitecture.com
www.trwarchitecture.com

LICENSED ARCHITECT AR 1710
THOMAS R. WILLIAMS
8-7-2018
STATE OF IDAHO

ADAMS COUNTY COMMUNITY CENTER
107 MICHIGAN STREET
COUNCIL, IDAHO

| | |
|------------------------------|--------------|
| Project Number | |
| Date: 10/24/2018 12:02:14 PM | |
| Drawn By: | Author |
| Checked By: | Checker |
| Revisions | |
| Revision 1 | MMDYYYY Y |

A5.0
WALL SECTIONS