

ADAMS COUNTY
ORDINANCE 2010-02

AN ORDINANCE ESTABLISHING A NEW MEADOWS AREA OF CITY IMPACT IN THE UNINCORPORATED PORTION OF ADAMS COUNTY SURROUNDING THE CITY OF NEW MEADOWS, IDAHO; ADOPTING AN OFFICIAL MAP OF THE NEW MEADOWS AREA OF CITY IMPACT; AND ESTABLISHING AN EFFECTIVE DATE HEREIN.

BE IT ORDAINED BY THE GOVERNING BOARD OF ADAMS COUNTY, IDAHO, as follows:

Section 1: New Meadows Area of City Impact Boundaries. An area of city impact for the City of New Meadows is established within the boundaries illustrated on the New Meadows Area of Impact map, attached hereto as Exhibit A, which map is hereby made a part of this Ordinance.

Section 2: Effective Date. This Ordinance shall be in full force and effect from and after its passage, approval and publication according to law.

Passed and approved by the Board of Adams County Commissioners this 25th day of October, 2010.

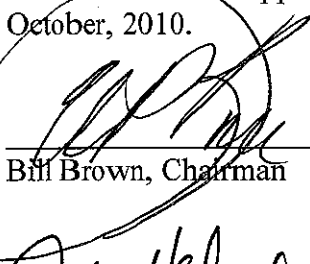

Bill Brown, Chairman

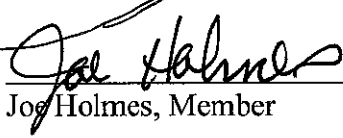

Joe Holmes, Member



Mike Paradis, Member

ATTEST:



Sherry Ward, County Clerk

[SEAL]

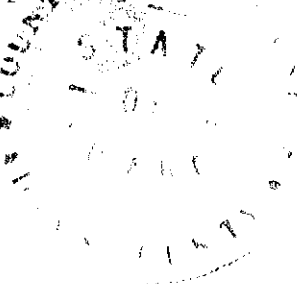

CITY OF NEW MEADOWS
ORDINANCE NO. 324-10

AN ORDINANCE ESTABLISHING A NEW MEADOWS AREA OF CITY IMPACT IN THE UNINCORPORATED PORTION OF ADAMS COUNTY SURROUNDING THE CITY OF NEW MEADOWS, IDAHO; ADOPTING AN OFFICIAL MAP OF THE NEW MEADOWS AREA OF CITY IMPACT; AND ESTABLISHING AN EFFECTIVE DATE HEREIN.

BE IT ORDAINED BY THE CITY COUNCIL OF THE CITY OF NEW MEADOWS, ADAMS COUNTY, IDAHO, as follows:

Section 1: New Meadows Area of City Impact Boundaries. An area of city impact for the City of New Meadows is established within the boundaries illustrated on the New Meadows Area of Impact map, attached hereto as Exhibit A, which map is hereby made a part of this Ordinance.

Section 2: Effective Date. This Ordinance shall be in full force and effect from and after its passage, approval and publication according to law.

Passed by the New Meadows City Council and approved by the Mayor this 10th day of May, 2010.

Gale Stillman
Gale Stillman, Mayor

ATTEST:

Jacob Qualls
Jacob Qualls, City Clerk

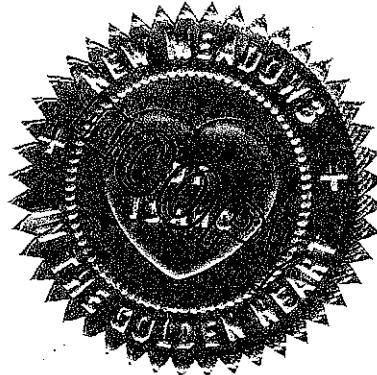

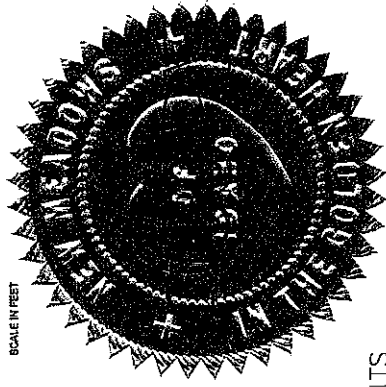
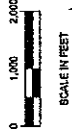
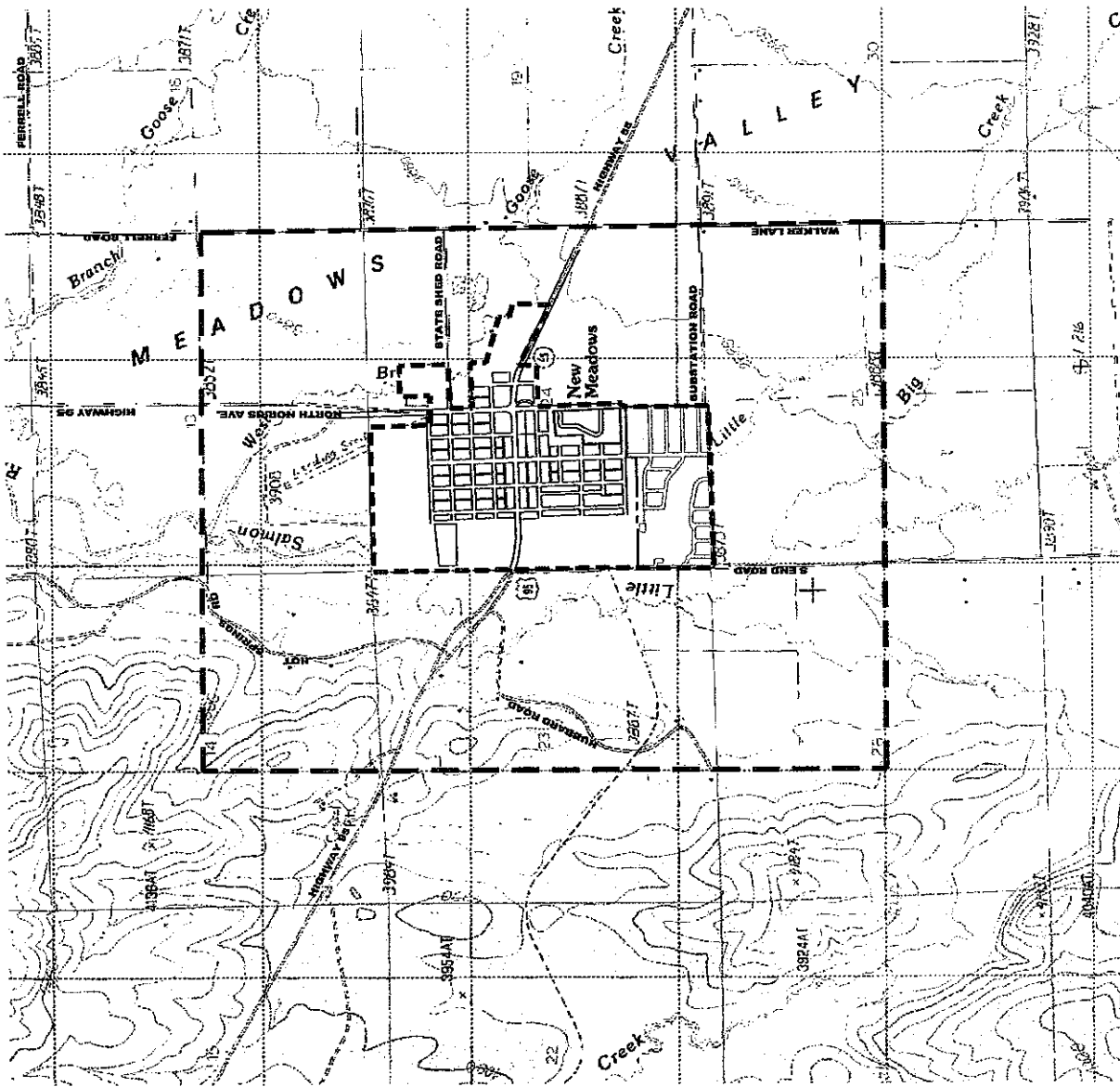

- CITY LIMITS
- PROPOSED IMPACT AREA

CITY OF NEW MEADOWS PROPOSED IMPACT AREA 2009

